

LORD WELLINGTON RESERVE

Directions:

- From Bashan Road southbound, turn left on Newberry Road. After .57 miles, preserve parking will be on your left.
- From Mt. Parnassus Road heading east, turn left (north) onto Schulman Veselak Road. Turn left onto Newberry Road and parking will be on your right.

NOTE: This preserve passes through wet terrain in some places. Appropriate footwear may be required during or after wet weather.

Report any problems during your visit to the East Haddam Land Use Office. 860-873-5031.

Trail Facts:

- The 0.7 mile red trail passes through both wetlands and uplands and follows the bank of a long stream along the preserve's western edge.

Permitted Activities:

- Hiking
- Nature study
- Snowshoeing
- Birding
- Cross-country skiing
- Archery hunting, by permit only.

No motorized vehicles allowed on the property.



EAST HADDAM
YOUTH AND FAMILY
SERVICES



EAST HADDAM TRAILS

LORD WELLINGTON RESERVE

The 28.49-acre Lord Wellington property was acquired by the Town of East Haddam in 2002 with the assistance of a grant from the Connecticut Department of Energy and Environmental Protection.

The property's name derives from Lord Wellington Cone, who was a local property owner in the 1850s.

There is a single loop trail on the property, accessible from the parking area on Newberry Road.

LORD WELLINGTON RESERVE

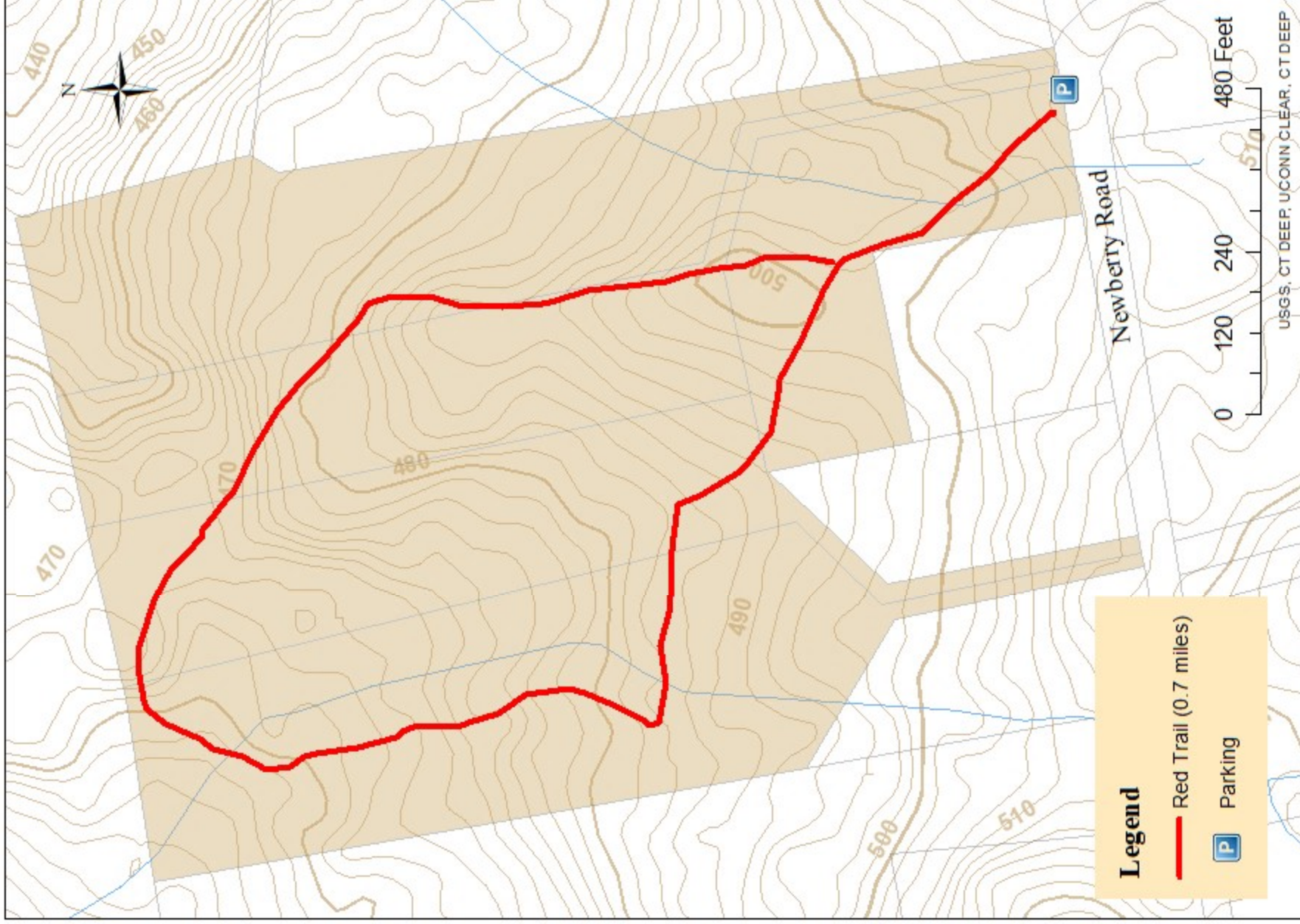

For general reference only

Managed by East Haddam Conservation Commission